

PHILIP WOOLLER

LET AGREED



THORPEBANK ROAD W12 • SHEPHERD'S BUSH
£595 PW / £2578 PCM



- 3 double bedrooms
- Shower room
- Bathroom en suite
- Kitchen / breakfast room
- Reception room
- Patio garden
- Modern kitchen and Bathroom
- Oak floors to ground floor

Type
Edwardian terraced house

Gross internal floor area
1098 sq ft / 102 sq m approx.

Nearest stations
Shepherd's Bush Market (Hamm & City
and Circle Lines)

Council Tax Band
E (£1500.34 PA)

PHILIP WOOLLER

LET AGREED



SECOND FLOOR
GROSS INTERNAL
FLOOR AREA 305 SQ FT

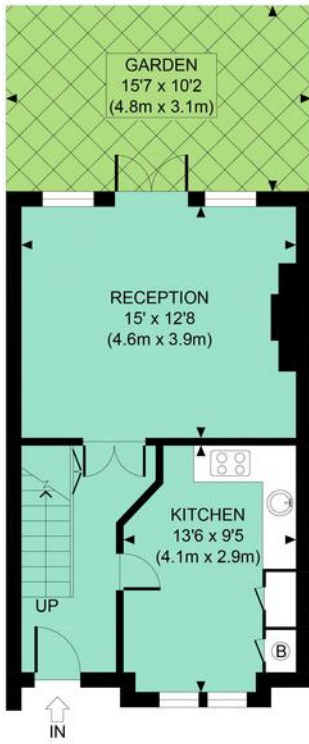

GROUND FLOOR
GROSS INTERNAL
FLOOR AREA 390 SQ FT

SHOWER ROOM
9'1 x 5'9
(2.8m x 1.8m)

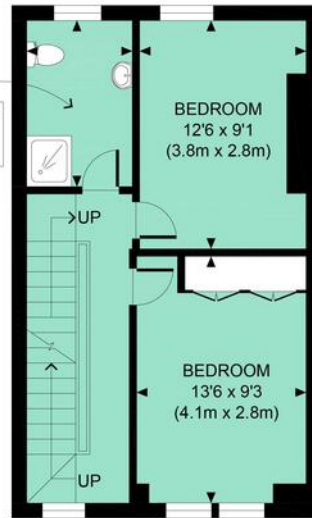

FIRST FLOOR
GROSS INTERNAL
FLOOR AREA 403 SQ FT

APPROX. GROSS INTERNAL FLOOR AREA WITH EAVES 1098 SQ FT / 102 SQM
APPROX. GROSS INTERNAL FLOOR AREA WITHOUT EAVES 1058 SQ FT / 98 SQM
Ref: Copyright **photo**plan

Disclaimer: Floor plan measurements are approximate and are for illustrative purposes only. While we do not doubt the floor plan accuracy and completeness, you or your advisors should conduct a careful, independent investigation of the property in respect of monetary valuation

PHILIP WOOLLER

LET AGREED

Score	Energy rating	Current	Potential
92+	A		
81-91	B		85 B
69-80	C		
55-68	D	58 D	
39-54	E		
21-38	F		
1-20	G		

The graph shows this property's current and potential energy rating.

Properties get a rating from A (best) to G (worst) and a score. The better the rating and score, the lower your energy bills are likely to be.

For properties in England and Wales:

- the average energy rating is D
- the average energy score is 60

IMPORTANT NOTICE

1. Particulars: These particulars are not an offer or contract, nor part of one. You should not rely on statements by Philip Wooller Ltd in the particulars or by word of mouth or in writing ('information') as being factually accurate about the property, its condition or its value. Neither Philip Wooller Ltd nor any joint agent has any authority to make any representations about the property, and accordingly any information given is entirely without responsibility on the part of the agents, seller(s) or lessor(s).

2. Photos etc: The photographs show

only certain parts of the property as they appeared at the time they were taken. Areas, measurements and distances given are approximate only.

3. Regulations etc: Any reference to alternations to, or use of, any part of the property does not mean that any necessary planning, building regulations or other consent has been obtained. A buyer or lessee must find out by inspection or in other ways that these matters have been properly dealt with and that all information is correct.

4. VAT: The position relating to the property may change without notice.