

# PHILIP WOOLLER

## LET



VALETTA ROAD W3 • ASKEW ROAD AREA  
£395 PW / £1711 PCM



- 2 double bedrooms
- Bathroom
- Reception room
- Kitchen / dining area open plan
- Large south facing garden
- Separate gated access at rear
- Close to Askew Road's shops and cafes

Type  
Ground floor garden flat

Gross internal floor area  
775 sq ft / 72 sq m approx.

Nearest stations  
Stamford Brook (District Line) and  
Turnham Green Terrace (District and  
Piccadilly Lines)

Council Tax Band  
D

# PHILIP WOOLLER

## LET

### Valetta Road, W3

Approximate gross internal area

72 sq m / 775 sq ft

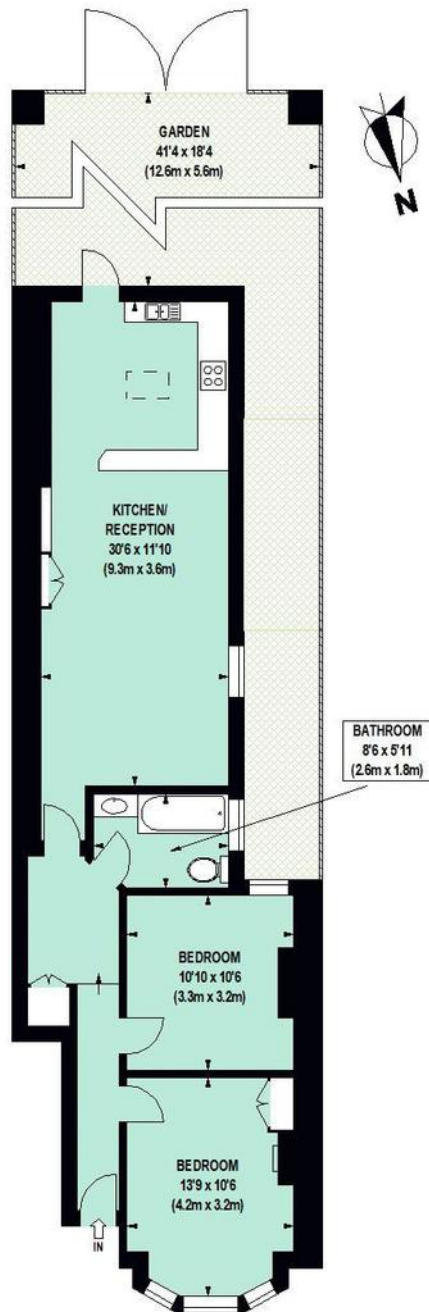

GROUND FLOOR

Floor Plan produced for Philip Wooller by Mays Floorplans. © . Tel 020 3397 4594  
Illustration for identification purposes only, not to scale  
All measurements are maximum, and include wardrobes and window bays where applicable

# PHILIP WOOLLER

## LET

### IMPORTANT NOTICE

---

1. Particulars: These particulars are not an offer or contract, nor part of one. You should not rely on statements by Philip Wooller Ltd in the particulars or by word of mouth or in writing ('information') as being factually accurate about the property, its condition or its value. Neither Philip Wooller Ltd nor any joint agent has any authority to make any representations about the property, and accordingly any information given is entirely without responsibility on the part of the agents, seller(s) or lessor(s).

2. Photos etc: The photographs show

---

only certain parts of the property as they appeared at the time they were taken. Areas, measurements and distances given are approximate only.

3. Regulations etc: Any reference to alternations to, or use of, any part of the property does not mean that any necessary planning, building regulations or other consent has been obtained. A buyer or lessee must find out by inspection or in other ways that these matters have been properly dealt with and that all information is correct.

4. VAT: The position relating to the property may change without notice.